



*jordanfishwick*

Barford Drive

£1,100 PCM





## Barford Drive, Cheshire, SK9 2GB

£1,100 PCM

FURNISHED AVAILABLE LATE JANUARY-  
VIEWING RECOMMENDED

Located on the ever popular Villas development to the North of Wilmslow town centre is this attractive and spacious ground floor apartment.

Being close to local shops and within easy reach of the A34 and Manchester International Airport along within walking distance of Wilmslow town centre and the train station

Communal entrance hall with intercom system, entrance hall, lounge with double doors opening to the front, modern fitted dining kitchen which comprises of fridge/freezer, washer/dryer, microwave and cooker. Two double bedrooms, and a modern bathroom suite with electric shower over bath. Private parking and communal gardens.

Contact Wilmslow 01625 536300. £1100.00pcm

### LOCATION

Turn on to The Villas development and take the first turning on the right to Barford Drive follow the road round and the apartment block can be found after a short distance

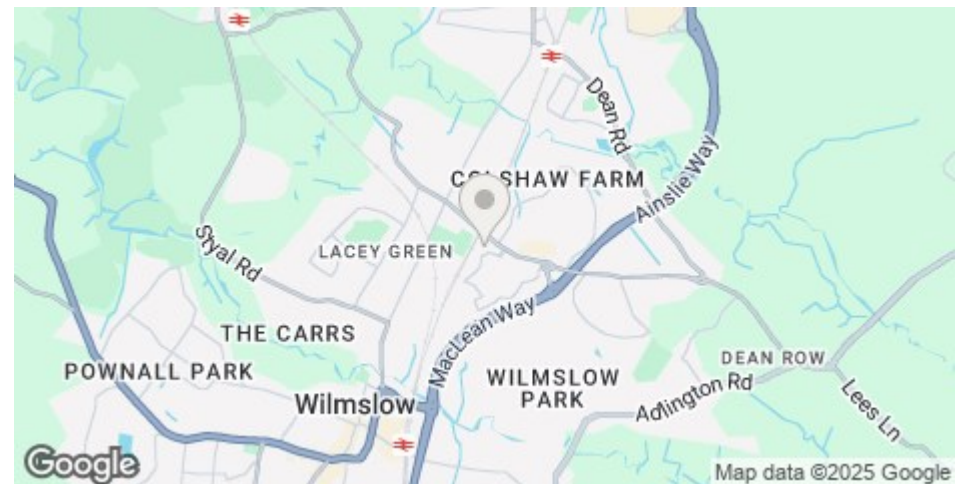

- GROUND FLOOR APARTMENT
- TWO DOUBLE BEDROOMS
- POPULAR LOCATION
- OFF ROAD PARKING
- EXCELLENT ACCESS TO A34 AND LOCAL SHOPS
- COUNCIL TAX C
- EPC D

Postcode - SK9 2GB

EPC Rating - D

Floor Area - sq ft

Local Authority - Cheshire East Council

Council Tax - C





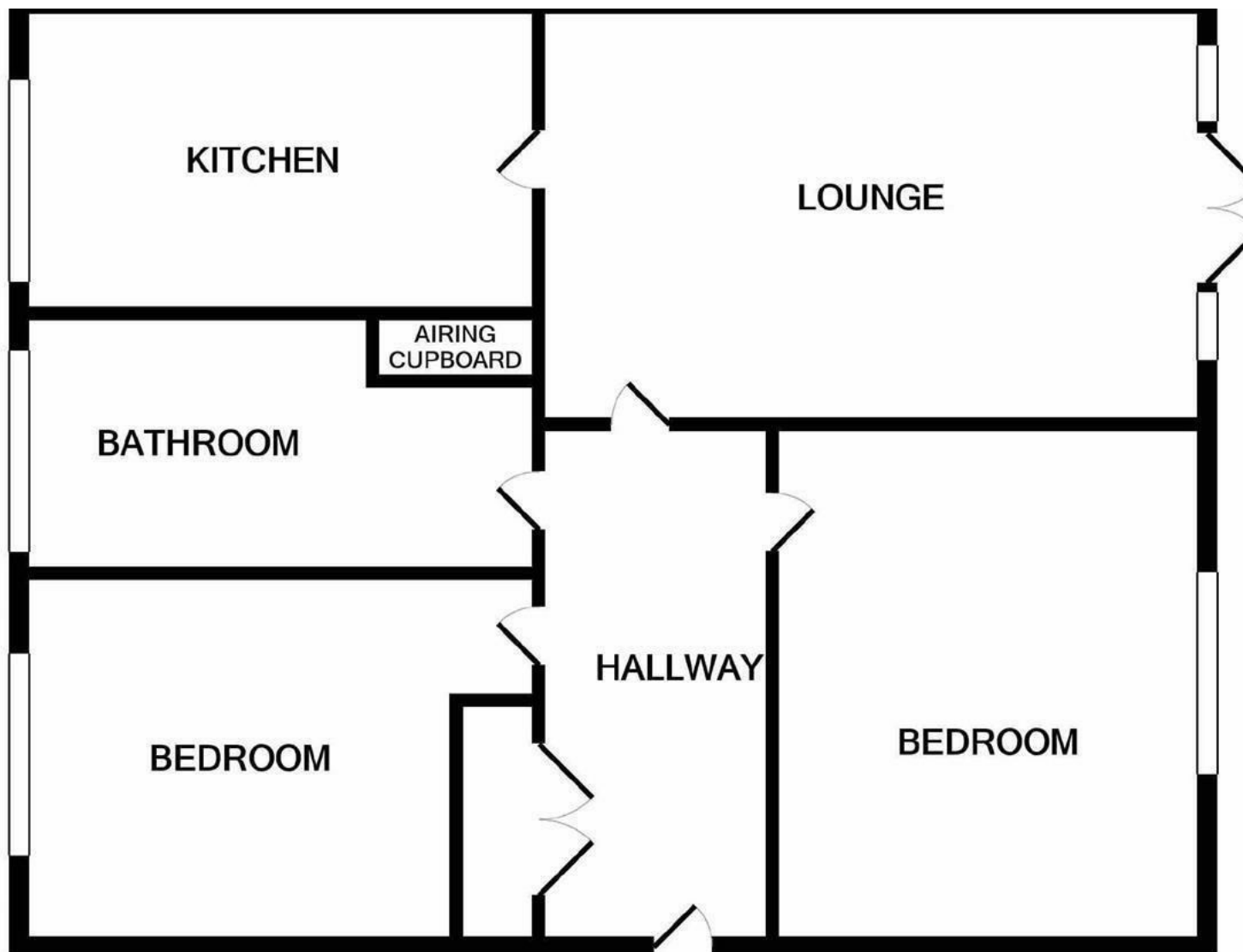

These particulars are believed to be accurate but they are not guaranteed and do not form a contract. Neither Jordan Fishwick nor the vendor or lessor accept any responsibility in respect of these particulars, which are not intended to be statements or representations of fact and any intending purchaser or lessee must satisfy himself by inspection or otherwise as to the correctness of each of the statements contained in these particulars. Any floorplans on this brochure are for illustrative purposes only and are not necessarily to scale.

Offices at: Offices at Chorlton, Didsbury, Disley, Hale, Glossop, Macclesfield, Manchester Deansgate, Manchester Whitworth Street, New Mills, Sale, Wilmslow and Withington

01625 536300